

March 6, 2024

RICCI MACHINE MANUFACTURING LTD.

1905 Albion Road
Etobicoke, Ontario M9W 5S8

Attention: Dino Ricci / 416.213.8244 / info@riccimachine.com

MAXCUT MV-1830 VERTICAL MACHINING CENTRE
(WITH FANUC 0i-MF CONTROL)

Dear Dino,

Thank you for the opportunity to quote the **MAXCUT MV-1830 VERTICAL MACHINING CENTRE** with the **FANUC 0i-MF CONTROL**.





MAXCUT MV-1830 VERTICAL MACHINING CENTRE SPECIFICATIONS

TABLE

table size	35.43" x 16.14"
distance between table and floor	32.28"
table load capacity	770 lbs.

TRAVEL

X-axis	30"
Y-axis	18"
Z-axis	20"
X/Y-axis motor torque	2 ft-lbs
Z-axis motor torque	6.15 ft-lbs
X/Y/Z-axis rapid traverse	1000"/minute
X/Y/Z-axis maximum cutting feed rate	500"/minute

SPINDLE

taper	CAT#40
maximum speed + drive system	10,000 rpm belt drive
spindle centre to guide ways	18.9"
spindle nose to table top	4" - 24"
motor	7.5/10 hp

AUTOMATIC TOOL CHANGER

number of tool pockets	24
tool taper	CAT#40
tool select by shortest path	bi-directional
maximum tool diameter with adjacent empty pockets	5.12"
maximum tool diameter with adjacent full pockets	3.5"
maximum tool length	13.77"
maximum tool weight	17.6 lbs.



ACCURACY

linear axes positioning accuracy	±0.0002"
linear axes repeatability	0.00008"

GENERAL

length x width x height	86.6" x 80.7" x 98.5"
weight	7986 lbs.
electric power	220V / 15kVa / 60amp

STANDARD + INCLUDED EQUIPMENT

- Fanuc Oi-MF control
- large fully ground work table with four (4) t-slots
- large front and side doors for easy work area accessibility
- automatic lubrication with low lubrication alarm
- coolant system with check valve + wash down coolant flush + 20bar through the spindle coolant + 210l coolant tank
- linear way system for high rapid / high accuracy traverse at all the axes
- full enclosure & heavy metal guarding with removable side doors
- telescopic way covers
- low voltage circuit system
- heat exchanger

MAXCUT MV-1830 VERTICAL MACHINING CENTRE PACKAGE PRICE: \$82,600 CANADIAN

MAXCUT MV-1830 VERTICAL MACHINING CENTRE LAY-OUT

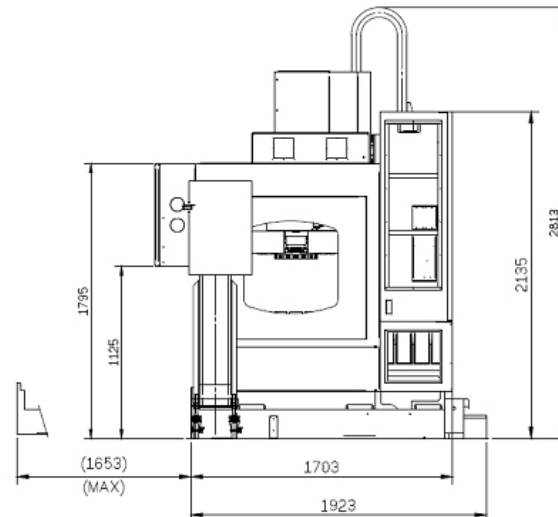
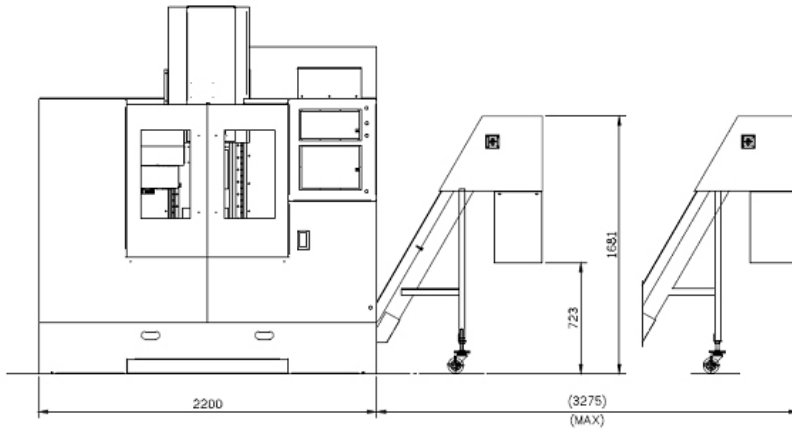
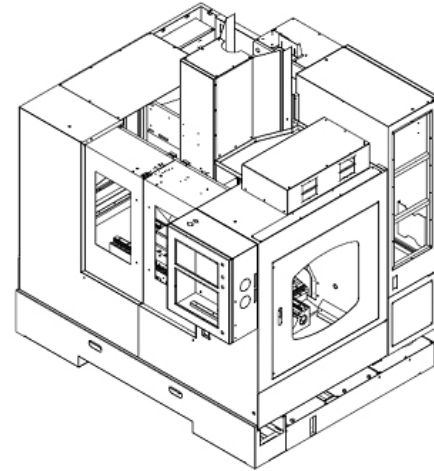
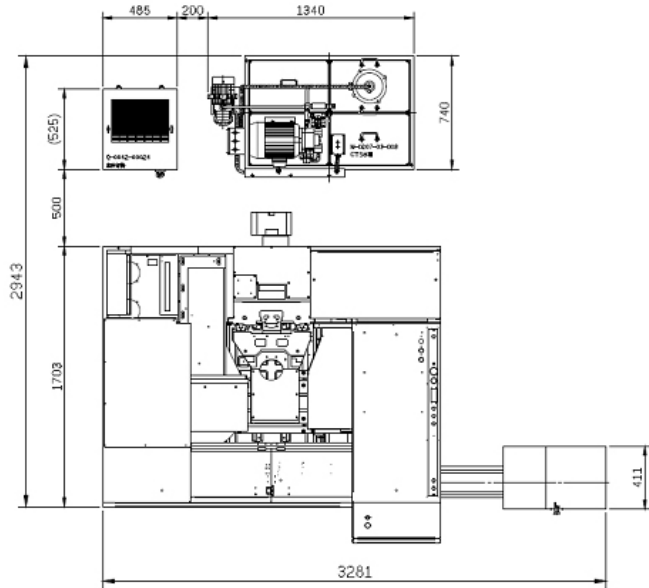



TERMS AND CONDITIONS

The pricing

The shown pricing is in Canadian Dollars F.O.B. truck loaded at the Masteel Oakville warehouse and is **for the quoted stock machine only**. Applicable taxes are extra. CSA approval is included in the pricing.

The payment terms

30% with order, 60% before pick-up, 10% 30 days after delivery.

Warranty

Twelve (12) months.

Delivery

Stock in Oakville, Ontario, **subject to prior sale**.

Customer's responsibility

Provide a single concrete slab level foundation per the machine foundation requirements, power to the machine by a certified electrician and hydraulic + way lube oil plus coolant for the machine.

Masteel's responsibility

Assemble / level the machine on the customer's shop floor, complete the machine installation and accuracy test and one day of basic machine operator training.

Pre-Start Health and Safety Review (PHSR) is the responsibility of the customer and is not included in the above pricing.

Please note that this quote is subject to change without notice.

Sincerely,

MASTEEL AMERICA CORPORATION

Ron Nater
Manager, Eastern Canada
647.270.4434 / ron@masteels.com / www.ronnater.ca

